



270

Fully refurbished
12,557 sq ft

OFFICE

270 Winnersh Triangle is a self-contained building within the courtyard setting beside 260 and 250/255.



Specification & Floorplans

GROUND FLOOR

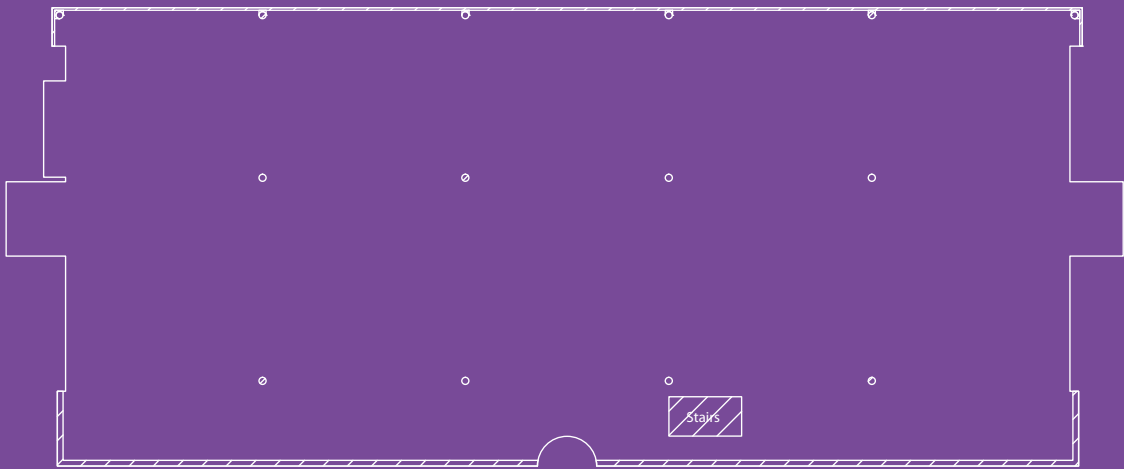

FIRST FLOOR

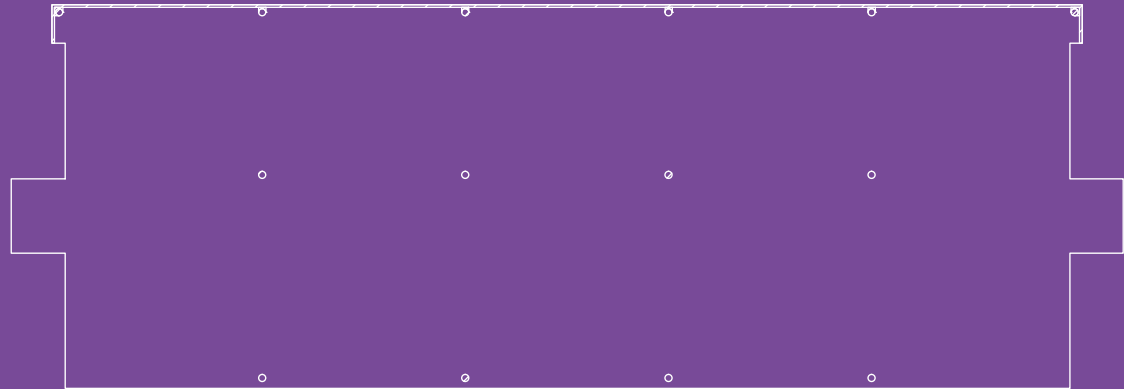

*Plans not to scale. Indicative Only.

270 Wharfedale Road	SQ FT	SQ M
First Floor	5,816	540.3
Ground Floor	6,960	646.6
TOTAL	12,776	1,186.9

Measurements are IPMS3.



- Two storey self-contained office fully refurbished to a Grade A standard
- Air conditioning
- 52 car parking spaces (1:246 sq ft)
- Full height glazing
- Full-access raised floors
- Male/Female WCs on each floor
- Showers on each floor
- Kitchen on each floor
- 1 x passenger lift
- Accessed via an engaging, double-height atrium reception
- EPC TBC following recent refurbishment

Location



BY RAIL FROM WINNERSH TRIANGLE

READING (DIRECT)	10 MINUTES
PADDINGTON	44 MINUTES
WATERLOO (DIRECT)	1 HOUR 15 MINUTES
GATWICK	1 HOUR 31 MINUTES
GUILDFORD	36 MINUTES

Source: National Rail enquiries. All times are fastest journeys. Extra trains may travel at peak times.



When it comes to transport connections, Winnersh Triangle is hard to better.

The Park has its own dedicated rail station, 'Winnersh Triangle', just a three minute walk from the Piazza, providing direct and frequent rail services to Central London and Reading, with trains running every 30 minutes.

A Park & Ride scheme operates from directly opposite 100 Berkshire Place, providing a bus service into central Reading throughout the day, departing every 15 minutes.

BY ROAD

M4 JUNCTION 10	2.2 MILES
READING	5.6 MILES
M25 JUNCTION 15	20.4 MILES
HEATHROW T1, 2 & 3	24.3 MILES
CENTRAL LONDON	38.7 MILES
GATWICK	62.4 MILES



Amenities



There's more to life than work...

...which is why we work hard to provide amenities that make life enjoyable.

The Holiday Inn is an AA 4-star hotel with a business centre, conference facilities and an AA 2-Rosette restaurant, Caprice.

The Esprit Fitness Centre and Spa has a 19-metre pool and well appointed gym, while Gather & Gather Café and Monty's bar provide options to eat and drink.

A WHSmith convenience store provides everyday amenities and a 14 screen cinema is located just a short walk from the Park.

There are a number of activities run and arranged by the Park management team, including classes, clinics, workshops and events, for everyone to enjoy.

We also have a nursery on the Park, helping to alleviate any unnecessary early-morning stress.



For more information on the exceptional opportunities at Winnersh Triangle please give us a call or visit our website:

www.winnershtriangle.co.uk

You can also find us on twitter



www.twitter.com/WinnershTri

Address

Winnersh Triangle Marketing Suite
Building 1000, Eskdale Road,
Winnersh Triangle, RG41 5TU



**BNP PARIBAS
REAL ESTATE**



**Vail
Williams**

Agents

Ed Smith
+44 20 7318 5136
edward.smith@realestate.bnpparibas

Kevin Cook
+44 118 909 7409
kcook@vailwilliams.com

Jeremy Metcalfe
+44 20 7318 5139
jeremy.metcalfe@realestate.bnpparibas

Charlie Nicholson
+44 118 909 7419
cnicholson@vailwilliams.com

MISREPRESENTATIONS ACT 1967 & DECLARATION

BNP Paribas Real Estate and Vail Williams for themselves and for the vendors of this property give notice that:
a) the particulars are set out as general outline only for the guidance of intending purchasers and do not constitute, nor constitute part of, an offer or contract; b) all descriptions, dimensions, references to condition and necessary permissions for use and occupation and other details are given in good faith and are believed to be correct, but any intending purchaser should not rely on them as statements or representations of fact but should satisfy themselves by inspection or otherwise as to the correctness of each of them; c) no person in the employment of BNP Paribas Real Estate and Vail Williams has any authority to make or give any representation or warranty what so ever in relation to this property. Subject to Contract. Exclusive of VAT.

February 2018. S099831 Siren | +44 (0)20 7478 8300 | sirendesign.co.uk